

KRY500 OSMOSIS UNIT

MANUAL

SMART WATER PURIFIER



KRYOMATECH
KRYOMATECH.COM

SARL KRYOMATECH

16 Rue Charles Lindbergh
38590 Saint-Etienne-de-Saint-Geoirs







Phone : 04 57 20 59 00





Mail: contact@kryomatech.com







1. Notice

Attention: Please strictly observe the following safety rules.

1. Do not use other accessories not authorized by the manufacturer to avoid damage to the machine.
2. Please check the machine and all accessories before installation.
3. Children are only allowed to maintain the machine under the supervision of a guardian.
4. If any malfunctions occur, please turn off the power supply, close the water inlet valve immediately, do not keep the machine in working mode.
5. This machine should only be repaired by authorized and qualified personnel.
6. The capacity to produce pure water depends on the quality, pressure, and temperature of the feed water. Abnormal values will result in a lower flow rate.

 FORBIDDEN	This sign indicates something forbidden		
 WARNING	This sign indicates a warning to follow the procedure precisely.		
 CAREFUL	This sign indicates to stay attentive and pay attention to actions.		
 Avoid direct contact with the sun	 Do not place in conditions below 4°C	 Do not place near flammable and/or explosive sources	

 WARNING		
 At the slightest mistake, immediately cut off the electricity and water supply.	 Keep out of reach of children.	 Call the help desk for any questions or services needed.

 CAREFUL		
 <p>Do not disassemble the machine without the guidance of a qualified professional.</p>	 <p>Use the machine in conditions ranging from 4 to 40°C</p>	 <p>Turn off the electricity and water supply if not in use for more than 24 hours.</p>
 <p>Use only the original accessories and cartridges provided by the manufacturer to ensure proper operation.</p>		 <p>Only qualified personnel are authorized to repair the machine.</p>

2. Product features

Product	Reverse osmosis water purifier
Reference	KRY500
Voltage and Frequency Rating	100V - 240V ~ 50/60Hz
Rated power	60 W
Water pressure	0.1 to 0.4 MPa
Water production	1.0L/min (this value is subject to change)
Max. capacity	2000L
Conditions	Ambient temperature 4-40°C Humidity<90%
Water source	Mains water
Product size	443 x 132 x 356 mm

3. Technical drawings

Reverse osmosis spare parts:

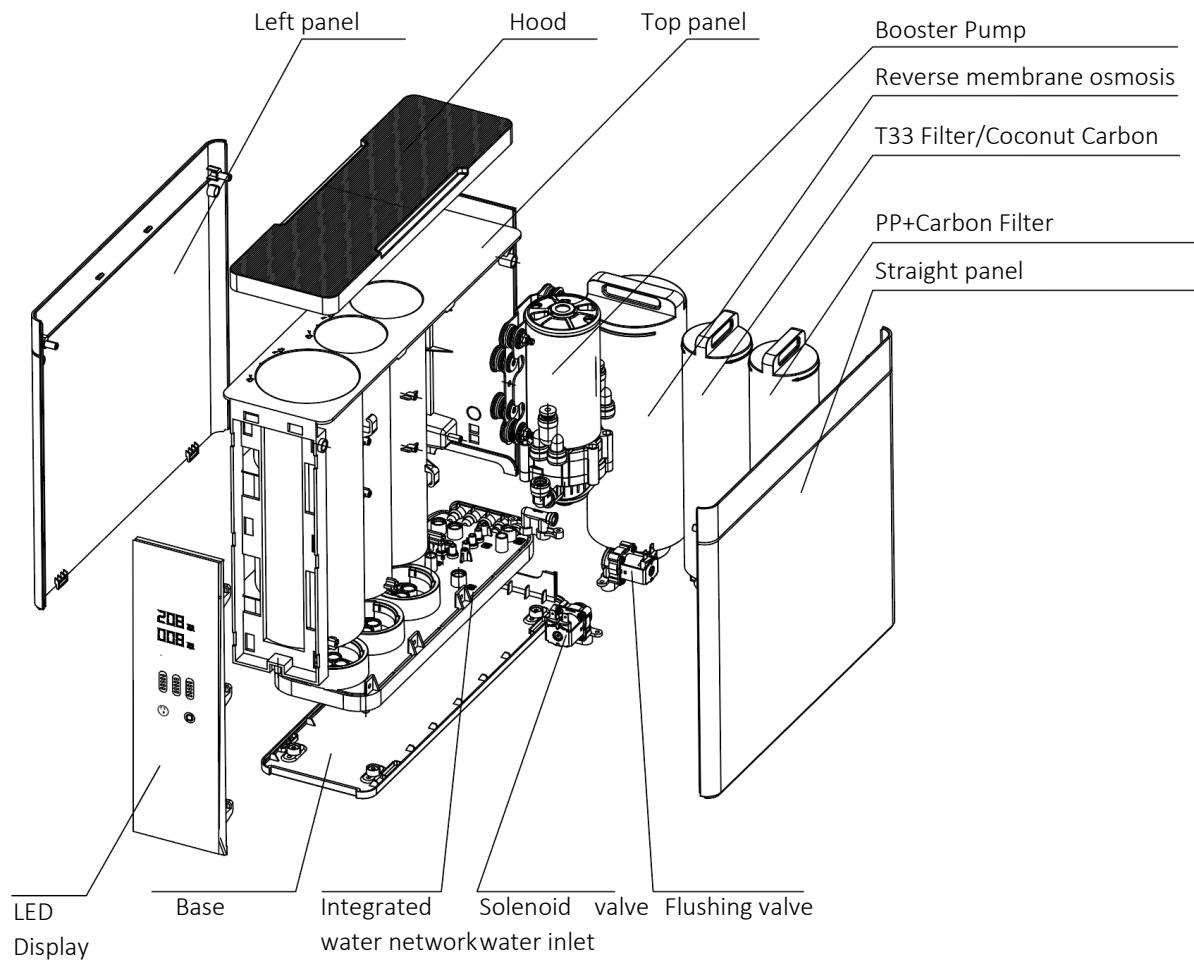

Technical principle:

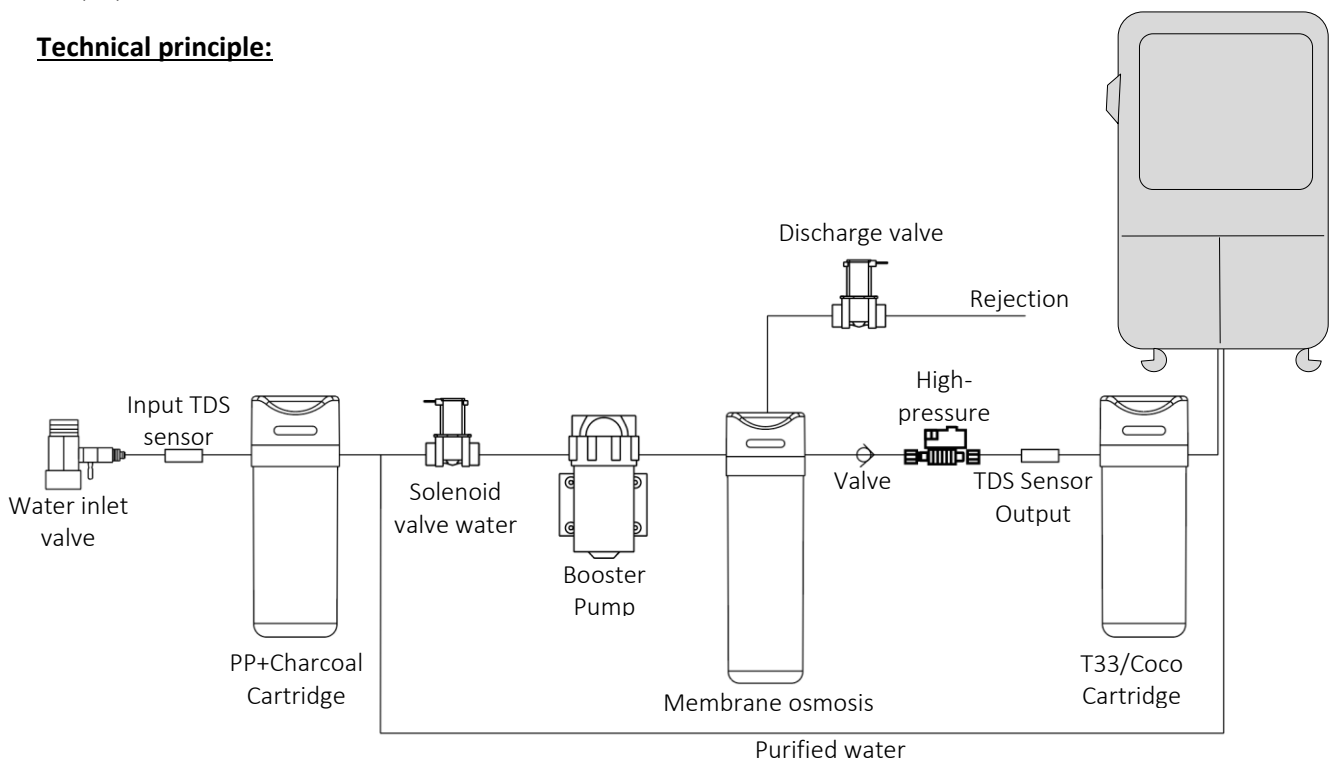

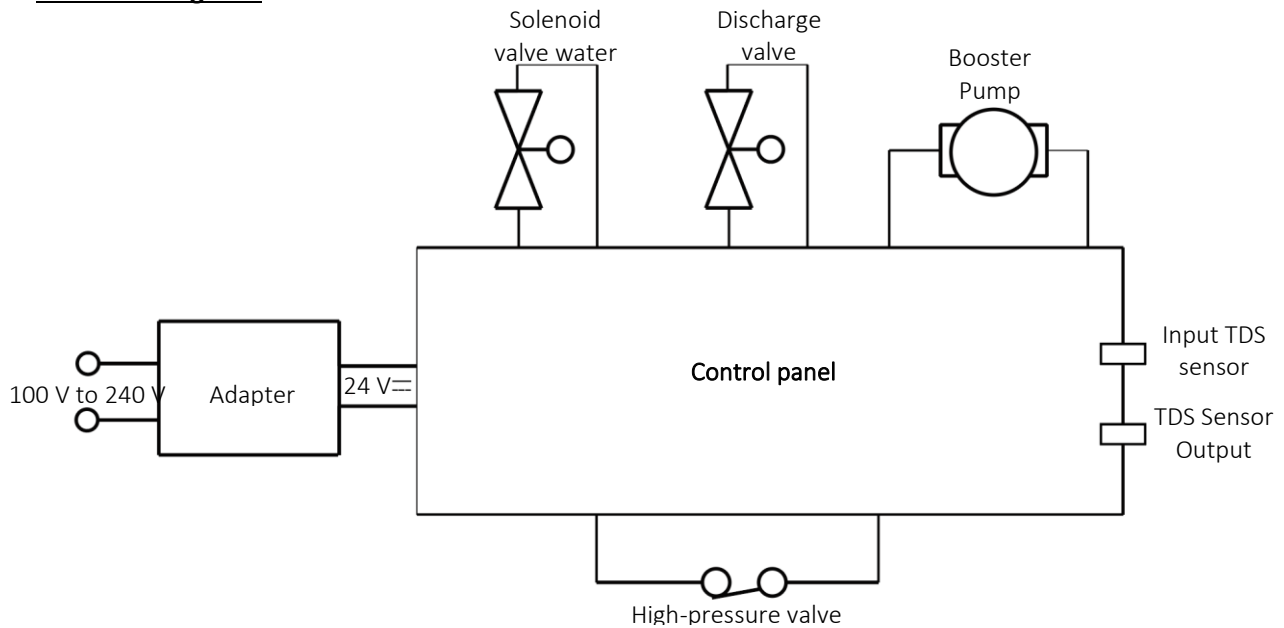
Electrical diagram:

4. Product Introduction

Product features:

Step 1: PP + Carbon Filter: Removes dirt, corrosion, sediment, sand, and other physical particles to protect the RO membrane.

Step 2: Reverse osmosis membrane: With a filtration accuracy of 0.0001 μ m, removes bacteria, viruses, antibiotics and other harmful substances, heavy metals and pesticide residues from the water.

Step 3: T33/Coco filter: Absorbs odours.

5. Installation

This machine must be installed by an authorized and qualified person only.

Check all accessories before installation.

5.1. Installation requirements

- The machine is equipped with a Booster pump to be used with only mains water.
- Check that the adapter used is the correct one and provides a voltage of 100V-240V.
- The environment of the facility must be clean and never in direct contact with the sun, high humidity, flammable and explosive products and hazardous electrical equipment.

Caution: When drilling is required for installation, be sure to observe safety and make sure there are no hidden water pipes, electrical wires, and gas hoses.

5.2. Installation of quick couplings

The quick coupling ports are placed on the inlet and outlet of the machine. The quick coupling is an orifice that can connect quickly and firmly without any tools.

- First, remove the Ω type clip from the orifice, push the movable plastic ring towards the orifice.
- Insert the PE hose into the hole in the quick coupling, then pull slightly to make a gap between the movable plastic ring and the port.
- Finally, insert the type Ω clip into the space between the fitting and the plastic ring.
- When you remove the PE hose from the quick connector, first remove the Ω type clip, push the movable plastic ring against the fixed part to release the hose, then you can remove it.
- Cut and connect the PE pipe and quick coupling

To connect: Remove the type Ω clip, cut the PE pipe straight and clean and insert it into the quick connector, then pull slightly to check that the PE pipe has been fixed in the O-ring of the quick connector, then finally insert the clip.

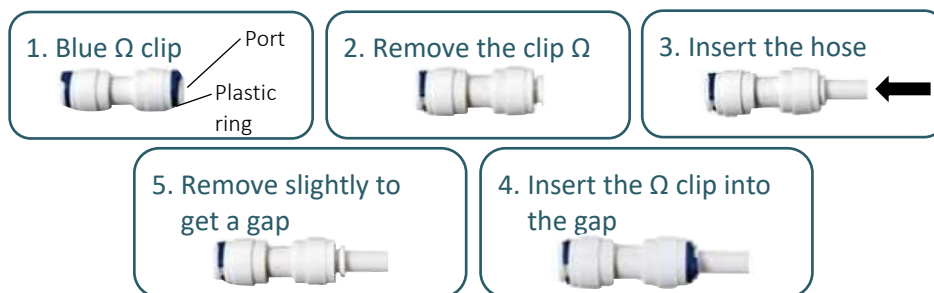

To disconnect: Remove the clip Ω , push the plastic ring against the fitting to release the hose. Remove the hose from the fitting.

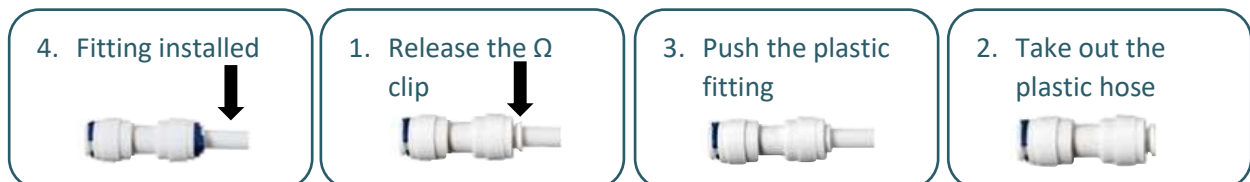

5.3. Cartridge Installation

- Remove the hood of the reverse unit
- Take the cartridges out of the carton and remove the plastic packaging.
- Install the cartridges according to the instructions on the top cover. Push to the bottom and then turn a quarter turn.
- After installation, replace the cover.

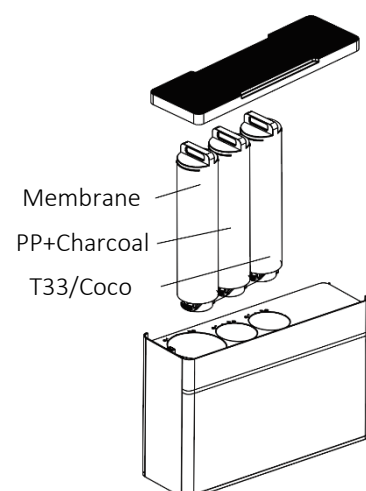

5.4. Location of the installation

Make sure to position the osmosis unit on a flat and stable surface. For ease of use, we recommend using a shut-off valve at the inlet of your equipment.

- Connect the PE water inlet hose from the valve to the reverse inlet port. Be sure to cut the necessary pipe size.

- Connect the purified water (drinking water consumption) by connecting the 1/4" hose of the outlet of the "Purify" device and then by connecting it quickly connected previously plugged under the "Purify" inlet of the faucet. Be sure to cut the necessary pipe size.
- Connect the reverse osmosis water (through filters and membrane) by connecting the 1/4" hose from the outlet of the "Drink" device and then connect the "Drink" inlet to the tap. Be sure to cut the necessary pipe size.
- Connect the discharge by connecting a 3/8" hose behind the machine to the "Drain" port to your water drainage system. Make sure to fix this hose correctly in the drain to prevent a leak.
- Place the cartridges in the machine before rinsing.
- After any cartridge installation, disconnect the process equipment, open the reverse osmosis water valve to flush the filter. Wait about 10-20 minutes until the water is clean. Then turn off the faucet and connect your equipment.

Careful:

- If the water does not come out, please check that the water inlet valve is open and that the machine is supplied with electricity.
- Rinse the filter cartridges according to the instructions.

5.5. First time use

When using for the first time, please open all valves.

When the water is running, turn off the equipment valve for 30 minutes and check for leaks. If there is no leakage, you can use the machine normally.

In normal user mode, keep the power connected, leave the equipment valve open.

When using the machine after a prolonged period of non-use, please open the valves and rinse the cartridges according to the instructions.

6. Usage

The machine is equipped with an LED display. When connecting the power supply, the machine will make a humming sound and go into flush mode.

6.1. Rinsing

Automatic Flushing: Whenever the power supply is connected, the machine will flush automatically. If the machine is not used for more than 72 hours, the machine will automatically rinse.

When flushing, the booster pump, water inlet solenoid valve and drain water are all in operation mode, the flush lasts 15 seconds, this will be indicated on the front panel.

If you press the "Select" button once, the machine will rinse for 30 seconds.

6.2. Purifier

Disconnect the machine inlet hose, open the valve and start filtering, the water solenoid valve and booster pump start working, this is indicated on the front panel.

6.3. Leak

In the event of a leak, the "Leak" indicator on the front panel will turn red and a 6-second alarm will be triggered. After fixing the problem, plug the power back in and restart the machine.

A leak sensor is present in the device. In a square shape with spikes, it plugs into the back of the machine in the "Leak" hole. The spikes are to be placed on the same surface as the osmosis unit and nearby.

If water touches this sensor, it will cause the device to fail.

Be careful not to place this sensor on a conductive surface so as not to cause the device to fail for no reason.

6.4. Defect

When filtering or rinsing continuously for 1 hour, the fault light will turn red during this time buzzing for 6 seconds until the problem is resolved to reconnect the power supply.

6.5. Cartridge life

The life of the filter is indicated on the front panel. With time and use, the bars will decrease. When the last bar has arrived, a 10-second alarm will go off. After that, another 3 times, every half hour, an alarm goes off.

6.6. Cartridge replacement

Press the "Reset" button for 3 seconds until you hear a sound. You must now select the cartridge to be reset by pressing "Select". When the cartridge to be reset flashes, press "Reset" for 3 seconds, until you hear a sound.

6.7. LED Display Content

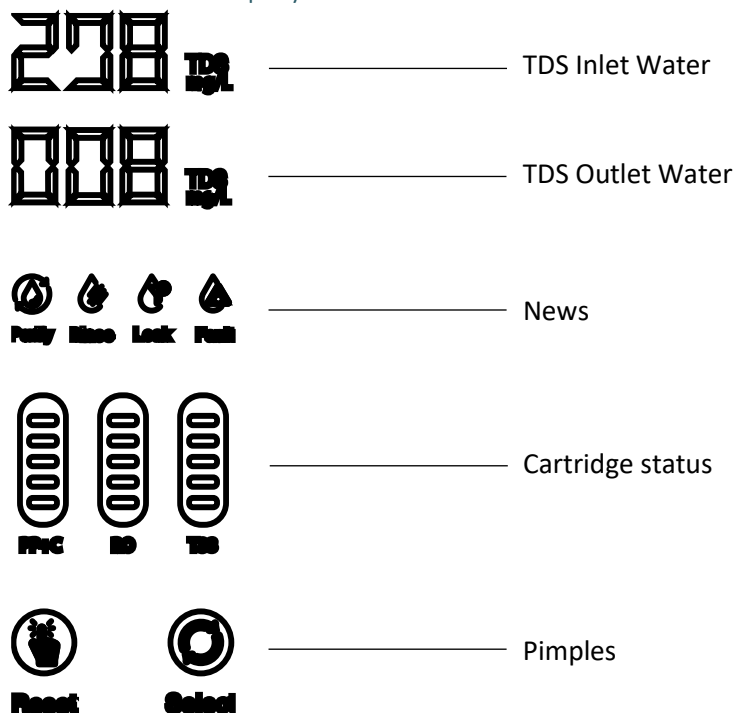

7. Maintenance:

Cartridge	PP + Charcoal	Membrane osmosis	T33/Coco
Frequency of change	6 months	18 months	12 months

The cartridge replacement time depends on the quality and use of the local water. The replacement time is for reference only.

Attention :

- Depending on the quality of the inlet water, please change the 1st stage cartridge (PP+Carbon) accordingly.
- When the TDS of drinking water rises rapidly, the reverse osmosis membrane must be replaced promptly.
- T33 is intended to improve the taste of drinking water, if the taste of water becomes bad or when the life of the cartridge has expired, please replace the T33 cartridge.

Cartridge Replacement :

Please change cartridges regularly to maintain effective and efficient filtration.

- Turn off the water supply, turn off the power supply and turn on the faucet/drain until the water stops flowing.
- Remove the lid and set it aside. Remove and install the cartridges as described.
- Please replace the cartridges by turning them and making sure they are in the correct position.
- The lifespan of a cartridge can vary depending on the region, water quality, season, and time of use. Please change them according to your use.

Machine maintenance:

- When cleaning the machine, do not use soap, detergent and other solvents that could damage the machine.
- Do not immerse the device in water. Make sure that the electronic parts are never in contact with water.

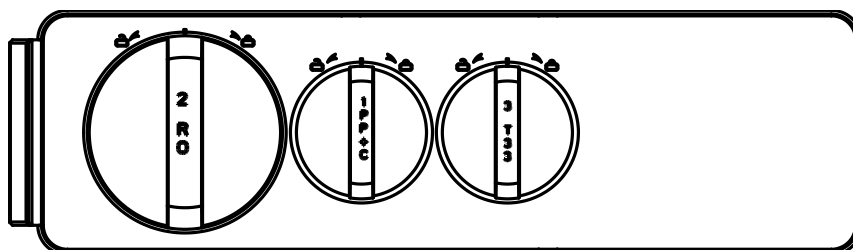

8. Troubleshooting

Common Outages	Possible reason	Solutions
Low or no flow	Twisted PE pipe	Untwist the hose
	The inlet valve is closed	Open the valve
	PP+C cartridge blocked	Replace the cartridge
	Low water pressure	Do a pre-treatment
	Inlet water temperature too low	Increase water temperature
Machine not working	Electrical fault	Control the power supply
	The adapter has lost efficiency	Replace the adapter
	Water Shut-off	Controlling the water supply
	Cartridges not replaced for a long time	Replace cartridges
Abnormal noise during water production	Power and voltage do not match	Call a professional to check and repair
	Inlet water flow too low	Increase the water flow before the unit
	Damaged adapter	Call a professional to check and repair
	Pump breakage	Call a professional to check and repair

If you have any doubts about your installation or a question, contact your dealer:

KRYOMATECH
KRYOMATECH.COM

SARL KRYOMATECH
16 Rue Charles Lindbergh
38590 Saint-Etienne-de-Saint-Geoirs

Phone : 04 57 20 59 00
Mail: contact@kryomatech.com